

CONSULTANT'S SEAL AND SIGNATURE REQUIRED. REPRODUCTION OF THIS DOCUMENT IS PROHIBITED. ANY REPRODUCTION OF THIS DOCUMENT WITHOUT THE WRITTEN PERMISSION OF WK DICKSON IS PROHIBITED.

SITE INFORMATION

PROJECT ADDRESS: 202 RALEIGH STREET
 NEW HANOVER COUNTY P.I.N.: R08500-007-037-000
 CURRENT ZONING DISTRICT: IND - INDUSTRIAL DISTRICT
 CURRENT LAND USE: MANUFACTURING
 LOT SIZE: 2,978,197.20 SF (68.37 ACRES)

BUILDING SIZE:
 EXISTING BUILDINGS: 502,427 SF
 BUILDING 1: 368,144 SF
 BUILDING 2: 52,668 SF
 BUILDING 3: 70,400 SF
 BUILDING 4: 2,975 SF
 BUILDING 5: 8,240 SF
 TOTAL BUILDING AREA: 502,427 SF
 % BUILDING LOT COVERAGE: 0.17%
 (502,427 SF / 2,978,197.20 SF) = 0.17%

OFF STREET PARKING CALCULATIONS (1 SPACE PER 1,500 GSF):

BUILDING AREA: 502,427 SF
 PARKING SPACES REQUIRED: 502,427 SF / 1,500 SF = 335 SPACES
 PARKING SPACES PROVIDED: 459 EXISTING PARKING SPACES*
 *75 EXISTING PARKING SPACES WILL BE RESTRIPEDED AT THEIR EXISTING DIMENSIONS FOR PHASE 1 SEE SHEET C3.3.
 HANDICAP PARKING SPACES REQUIRED: 3 PARKING SPACES
 HANDICAP PARKING SPACES PROVIDED: 4 PARKING SPACES
 BICYCLE PARKING SPACES REQUIRED: 5 PARKING SPACES
 BICYCLE PARKING SPACES PROVIDED: 5 PARKING SPACES

CAMA LAND USE CLASSIFICATION: URBAN
 RECEIVING STREAM, CLASS & INDEX: CAPE FEAR RIVER; SC; 18-(71)

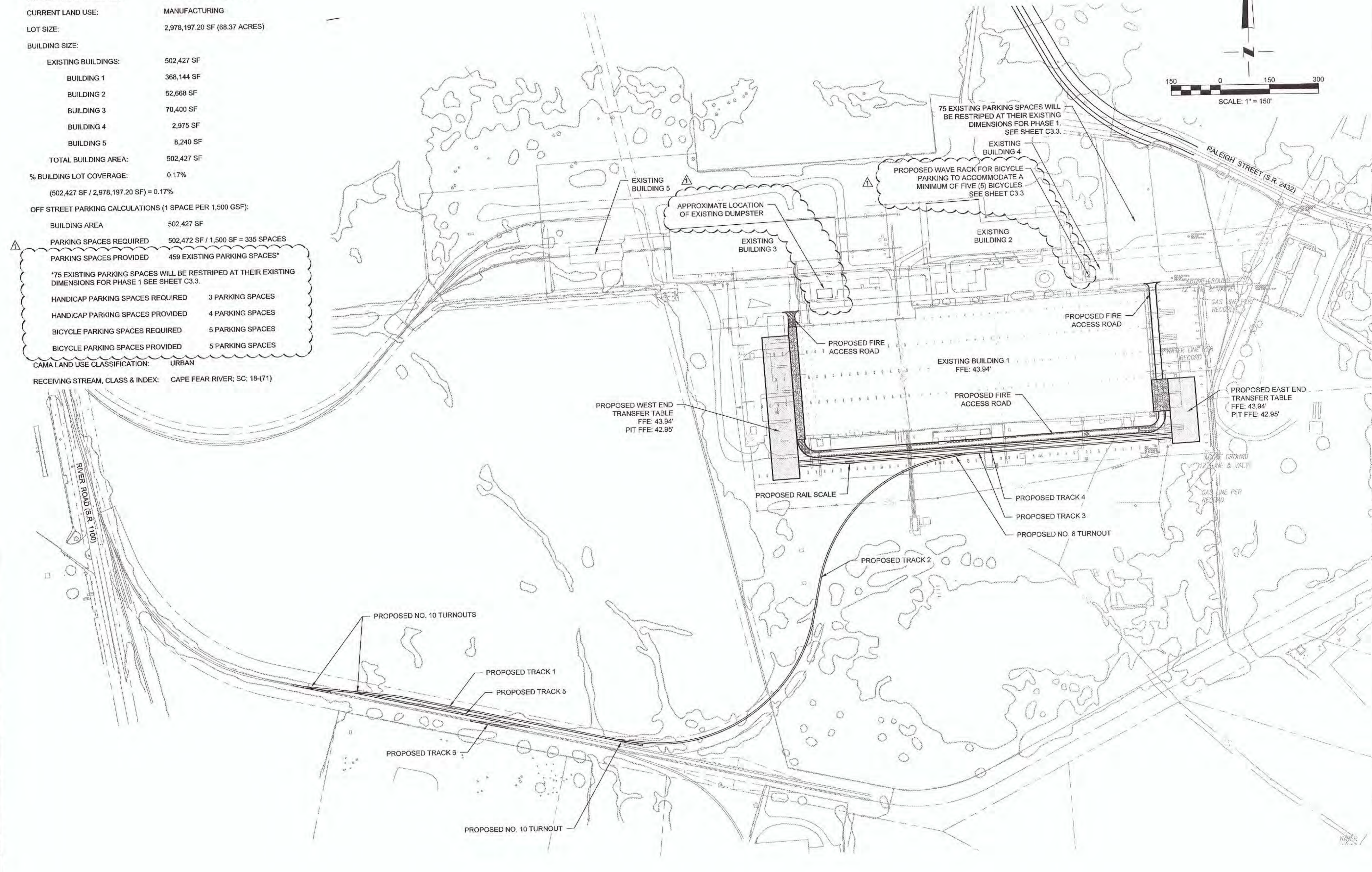
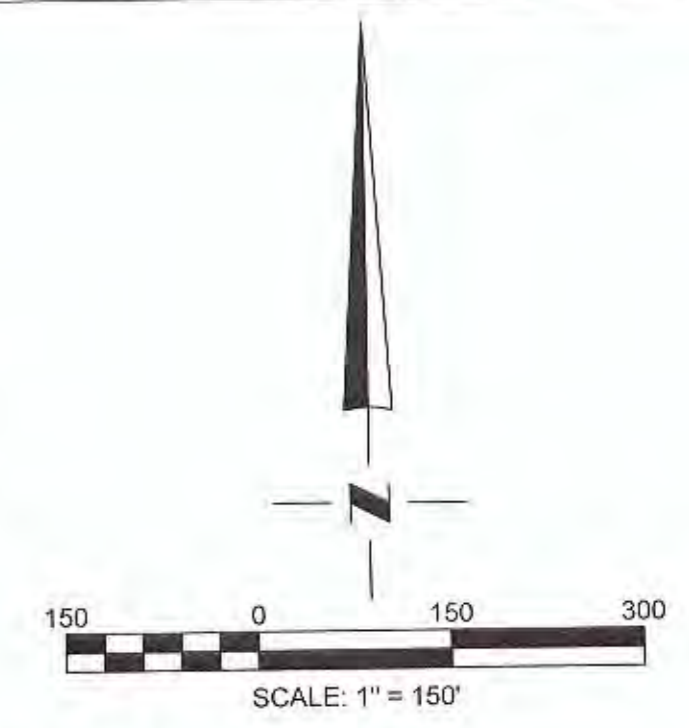

WK DICKSON
 community infrastructure consultants
 908 MARKET STREET
 WILMINGTON, NC 28401
 (910) 762-4201
 (910) 762-4200
 WWW.WKDICKSON.COM
 NC LICENSE NO. F-0374

PROFESSIONAL SEAL
 DANIEL E. DAWSON
 10357
 ENGINEER
 NORTH CAROLINA

NO.	DATE	TRC COMMENTS	DESCRIPTION
1	8/26/2015		

PROJECT NAME: RAIL AND SITE IMPROVEMENTS PHASE 1 FOR VERTIX RAILCAR CORPORATION 202 RALEIGH STREET WILMINGTON, NORTH CAROLINA 28412
DRAWING TITLE: OVERALL SITE PLAN

PROJ. MGR.: DLF
 DESIGN BY: DED
 DRAWN BY: TJC
 PROJ. DATE: AUGUST 2015
 DRAWING NUMBER:

C3.0
 WKD PROJ. NO.: 20150016.00.WL

PRELIMINARY - DO NOT USE FOR CONSTRUCTION PLOT DATE: 9/3/2015

CONTRACTOR SHALL BE RESPONSIBLE FOR OBTAINING ALL NECESSARY PERMITS AND APPROVALS FROM THE LOCAL, STATE AND FEDERAL AGENCIES. THE CONTRACTOR SHALL BE RESPONSIBLE FOR OBTAINING ALL NECESSARY PERMITS AND APPROVALS FROM THE LOCAL, STATE AND FEDERAL AGENCIES. THE CONTRACTOR SHALL BE RESPONSIBLE FOR OBTAINING ALL NECESSARY PERMITS AND APPROVALS FROM THE LOCAL, STATE AND FEDERAL AGENCIES.

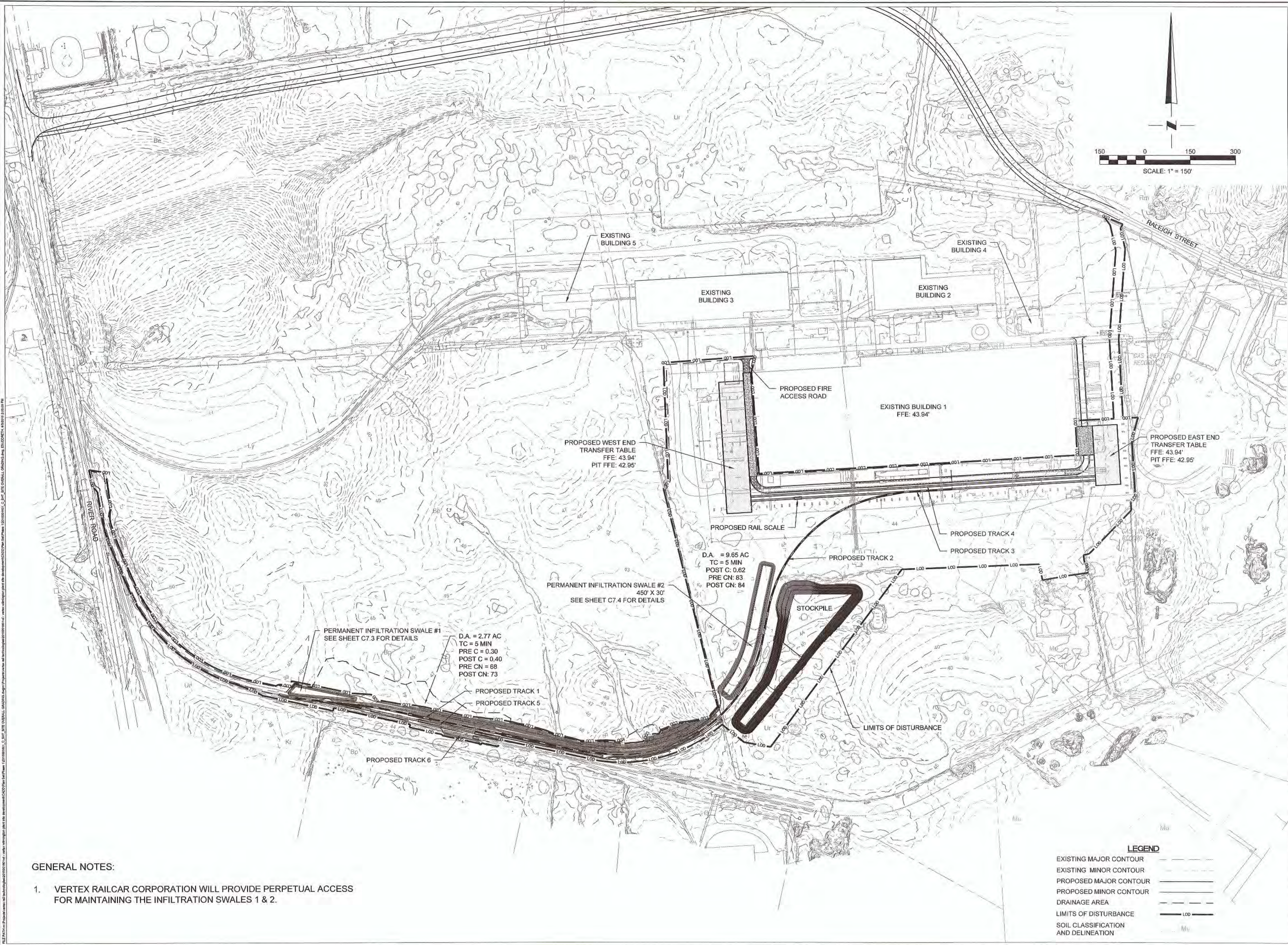

GENERAL NOTES:

1. VERTEX RAILCAR CORPORATION WILL PROVIDE PERPETUAL ACCESS FOR MAINTAINING THE INFILTRATION SWALES 1 & 2.

LEGEND

EXISTING MAJOR CONTOUR	———
EXISTING MINOR CONTOUR	———
PROPOSED MAJOR CONTOUR	———
PROPOSED MINOR CONTOUR	———
DRAINAGE AREA	———
LIMITS OF DISTURBANCE	———
SOIL CLASSIFICATION AND DELINEATION	Mu

WK DICKSON
 community infrastructure consultants
 909 MARKET STREET
 WILMINGTON, NC 28401
 (t) (910) 762-4201
 (f) (910) 762-4200
 WWW.WKDICKSON.COM
 NC LICENSE NO. F-0374



NO.	DATE	DESCRIPTION

PROJECT NAME: RAIL AND SITE IMPROVEMENTS PHASE 1 FOR VERTEX RAILCAR CORPORATION
 202 RALEIGH STREET
 WILMINGTON, NORTH CAROLINA 28412
 DRAWING TITLE: OVERALL GRADING AND DRAINAGE PLAN
 PLOT DATE: 9/3/2015

PROJ. MGR.: DLF
 DESIGN BY: DED
 DRAWN BY: TJC
 PROJ. DATE: AUGUST 2015
 DRAWING NUMBER: **C5.0**
 WKD PROJ. NO.: 20150016.00.WL

PRELIMINARY - DO NOT USE FOR CONSTRUCTION

CONTRACTOR SHALL BE RESPONSIBLE FOR OBTAINING ALL NECESSARY PERMITS AND EASEMENTS FROM THE APPROPRIATE AGENCIES. THE CONTRACTOR SHALL BE RESPONSIBLE FOR OBTAINING ALL NECESSARY PERMITS AND EASEMENTS FROM THE APPROPRIATE AGENCIES. THE CONTRACTOR SHALL BE RESPONSIBLE FOR OBTAINING ALL NECESSARY PERMITS AND EASEMENTS FROM THE APPROPRIATE AGENCIES.

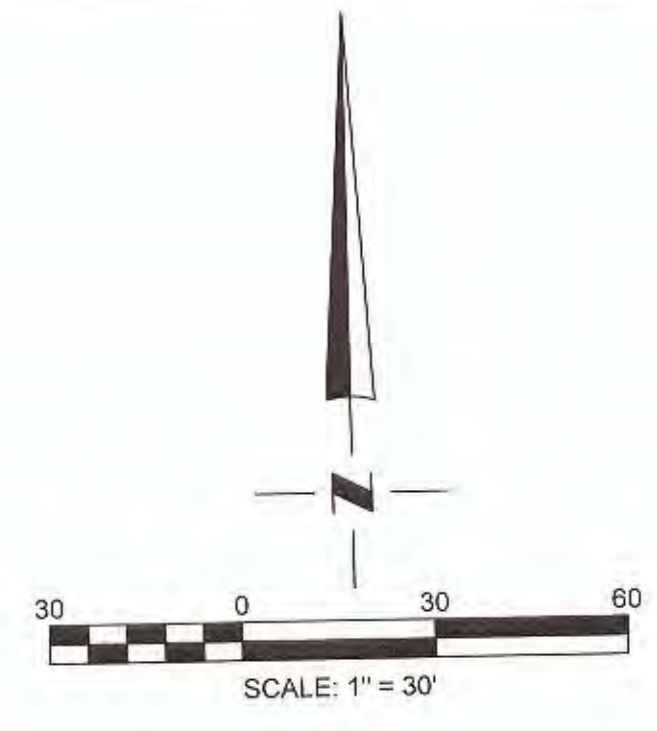
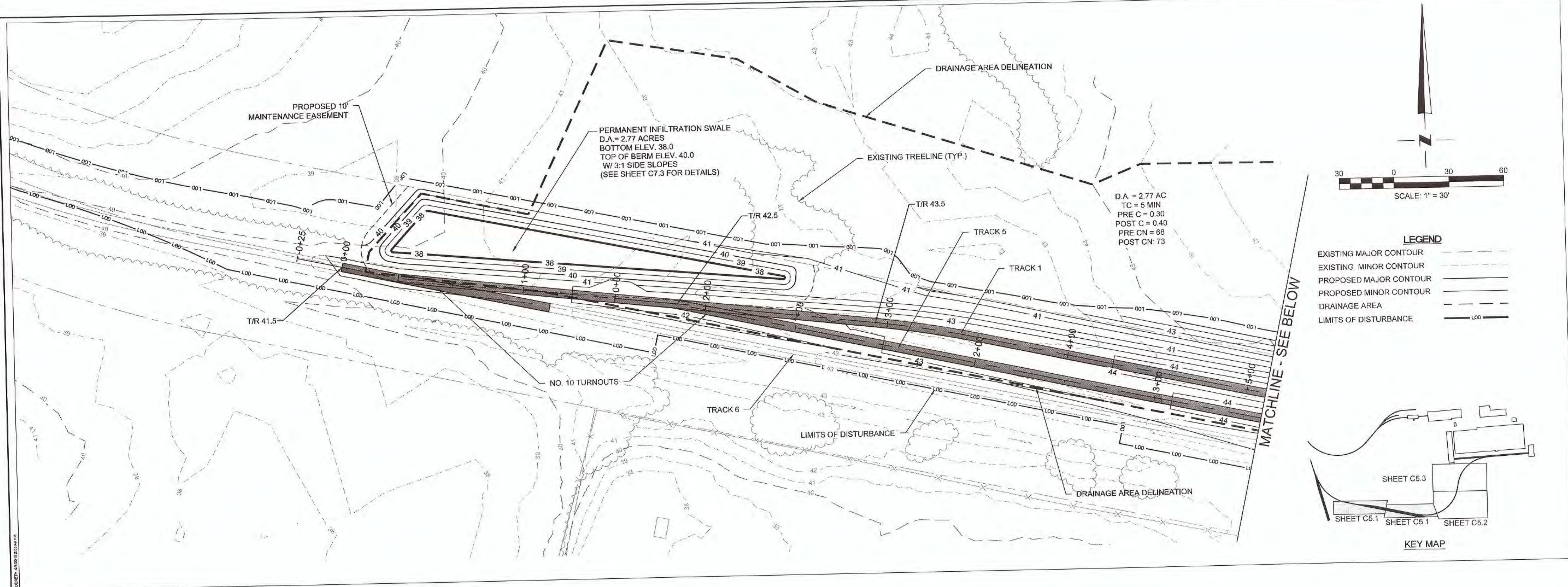

LEGEND

EXISTING MAJOR CONTOUR	---
EXISTING MINOR CONTOUR	- - -
PROPOSED MAJOR CONTOUR	---
PROPOSED MINOR CONTOUR	- - -
DRAINAGE AREA	---
LIMITS OF DISTURBANCE	---

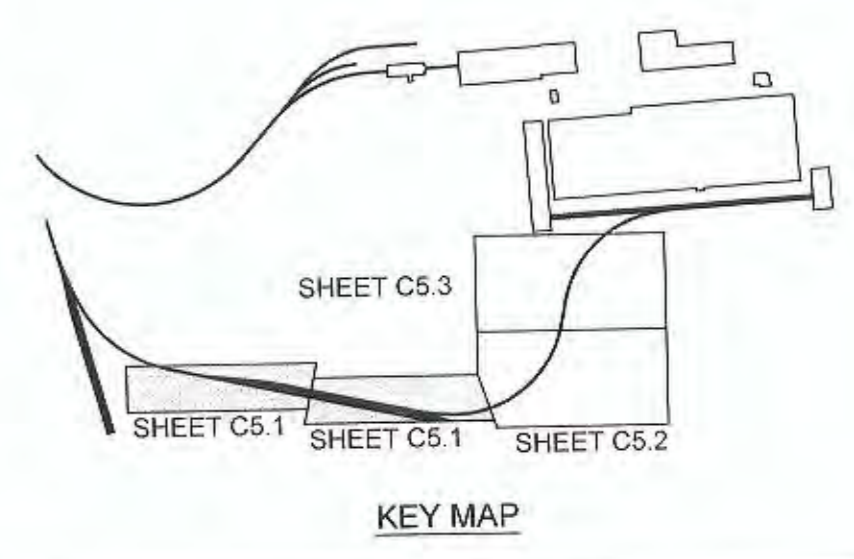

WK DICKSON
 community infrastructure consultants
 909 MARKET STREET
 WILMINGTON, NC 28401
 (t) (910) 762-4201
 (f) (910) 762-4200
 WWW.WKDICKSON.COM
 NC LICENSE NO. F-0374



NO.	DATE	DESCRIPTION

PRELIMINARY - DO NOT USE FOR CONSTRUCTION PLOT DATE: 9/3/2015

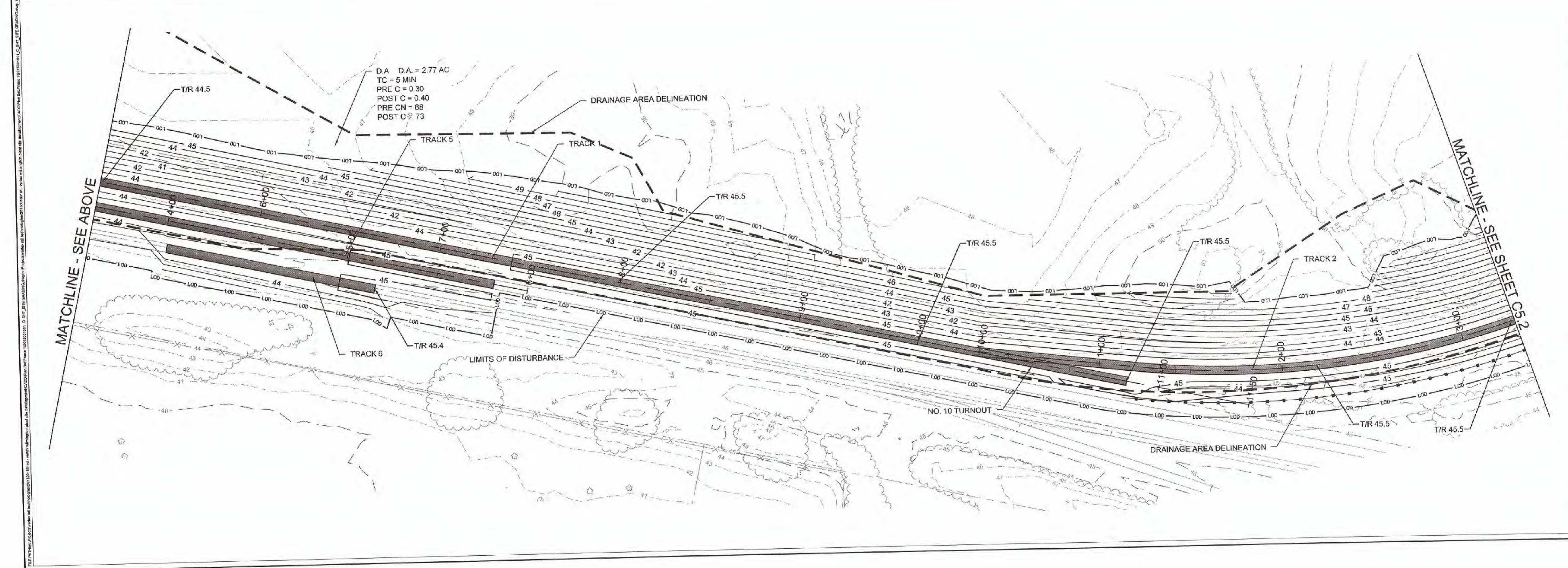

PROJECT NAME: RAIL AND SITE IMPROVEMENTS PHASE 1
 FOR
 VERTEX RAILCAR CORPORATION
 202 RALEIGH STREET
 WILMINGTON, NORTH CAROLINA 28412
 DRAWING TITLE: SITE GRADING AND DRAINAGE PLAN - SHEET 1

PROJ. MGR.: DLF
 DESIGN BY: DED
 DRAWN BY: TJC
 PROJ. DATE: AUGUST 2015
 DRAWING NUMBER:
C5.1
 WKD PROJ. NO.:
 20150016.00.WL

THIS DRAWING IS THE PROPERTY OF WK DICKSON AND SHOULD NOT BE REPRODUCED OR TRANSMITTED IN ANY FORM OR BY ANY MEANS, ELECTRONIC OR MECHANICAL, INCLUDING PHOTOCOPYING, RECORDING, OR BY ANY INFORMATION STORAGE AND RETRIEVAL SYSTEM, WITHOUT THE WRITTEN CONSENT OF WK DICKSON, INC. IF ANY DOCUMENT, INSTRUMENT OR OTHER RECORD OF THIS DRAWING IS LOST, STOLEN, DESTROYED, DAMAGED, OR IN ANY MANNER BECOMES UNRELIABLE, THE USER SHALL BE RESPONSIBLE FOR OBTAINING A COPY OF THE ORIGINAL DRAWING FROM THE ARCHIVE.

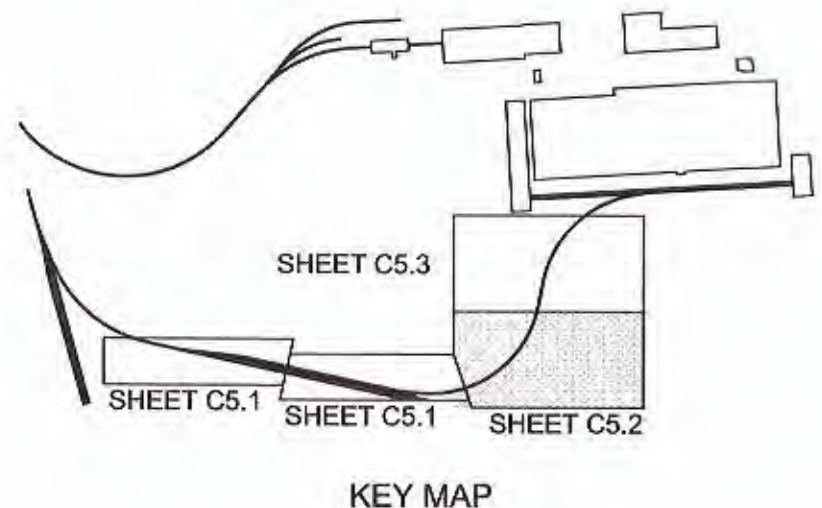

- LEGEND**
- EXISTING MAJOR CONTOUR
 - EXISTING MINOR CONTOUR
 - PROPOSED MAJOR CONTOUR
 - PROPOSED MINOR CONTOUR
 - DRAINAGE AREA
 - LIMITS OF DISTURBANCE

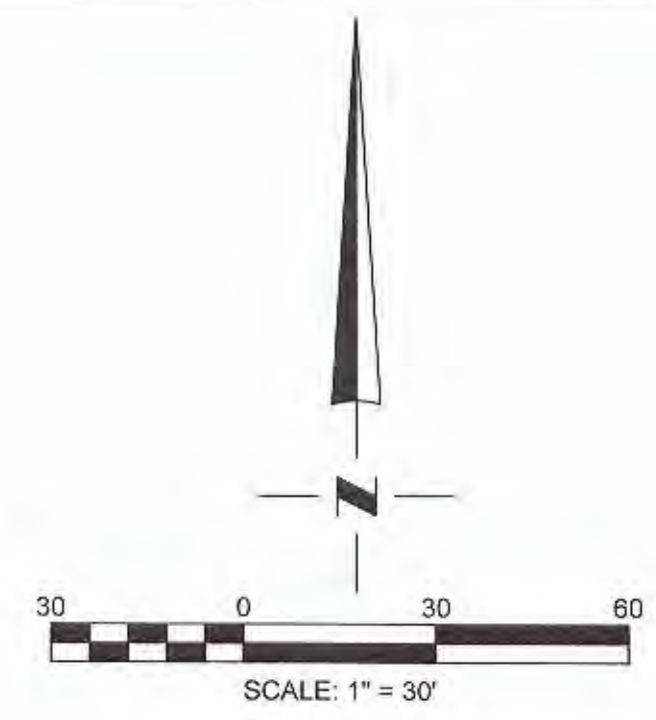

MATCHLINE - SEE SHEET C5.3

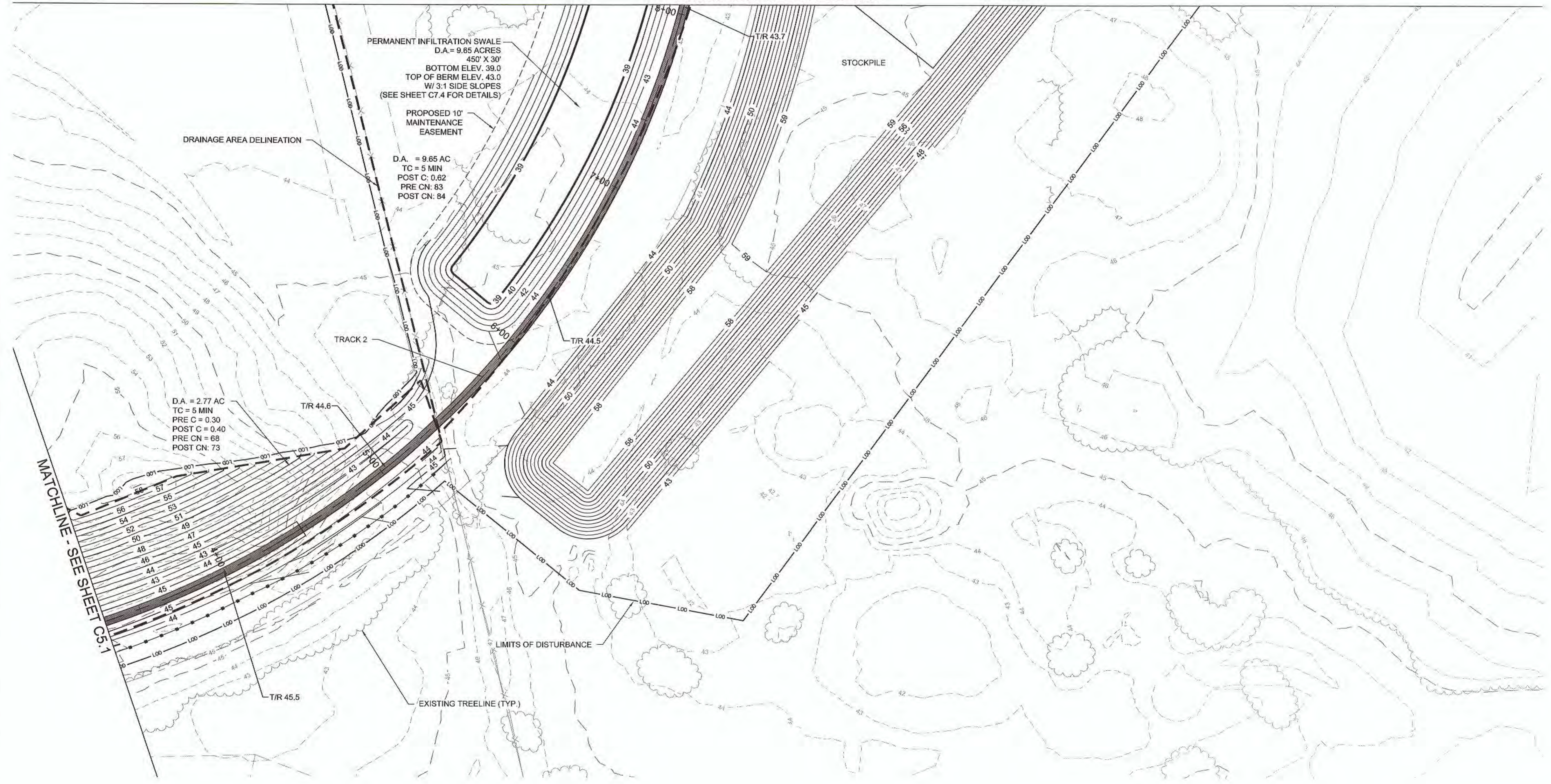

WK DICKSON
community infrastructure consultants

909 MARKET STREET
WILMINGTON, NC 28401
(t) (910) 762-4201
(f) (910) 762-4200

WWW.WKDICKSON.COM
NC LICENSE NO. F-0374



NO.	DATE	DESCRIPTION	BY

PROJECT NAME: RAIL AND SITE IMPROVEMENTS PHASE 1 FOR VERTEX RAILCAR CORPORATION
202 RALEIGH STREET
WILMINGTON, NORTH CAROLINA 28412

DRAWING TITLE: SITE GRADING AND DRAINAGE PLAN - SHEET 2

PROJ. MGR.: DLF
DESIGN BY: DED
DRAWN BY: TJC
PROJ. DATE: AUGUST 2015
DRAWING NUMBER:

C5.2
WKD PROJ. NO.: 20150016.00.WL

PRELIMINARY - DO NOT USE FOR CONSTRUCTION PLOT DATE: 9/3/2015

CONTRACTOR SHALL BE RESPONSIBLE FOR OBTAINING ALL NECESSARY PERMITS AND APPROVALS FROM ALL APPLICABLE AGENCIES AND AUTHORITIES. THE CONTRACTOR SHALL BE RESPONSIBLE FOR OBTAINING ALL NECESSARY PERMITS AND APPROVALS FROM ALL APPLICABLE AGENCIES AND AUTHORITIES. THE CONTRACTOR SHALL BE RESPONSIBLE FOR OBTAINING ALL NECESSARY PERMITS AND APPROVALS FROM ALL APPLICABLE AGENCIES AND AUTHORITIES.

CONSTRUCTION SEQUENCE:

- ONCE SITE IS STABILIZED, SEDIMENT FROM TEMPORARY SEDIMENT BASIN #1 SHALL BE REMOVED AND INFILTRATION BASIN #1 SHALL BE CONSTRUCTED PER PLAN.

NOTES:

- VERTEX RAILCAR CORPORATION WILL PROVIDE PERPETUAL ACCESS FOR MAINTAINING THE INFILTRATION SWALE.
- A PUMP WILL BE USED TO DEWATER THE BASIN FOR MAINTENANCE.

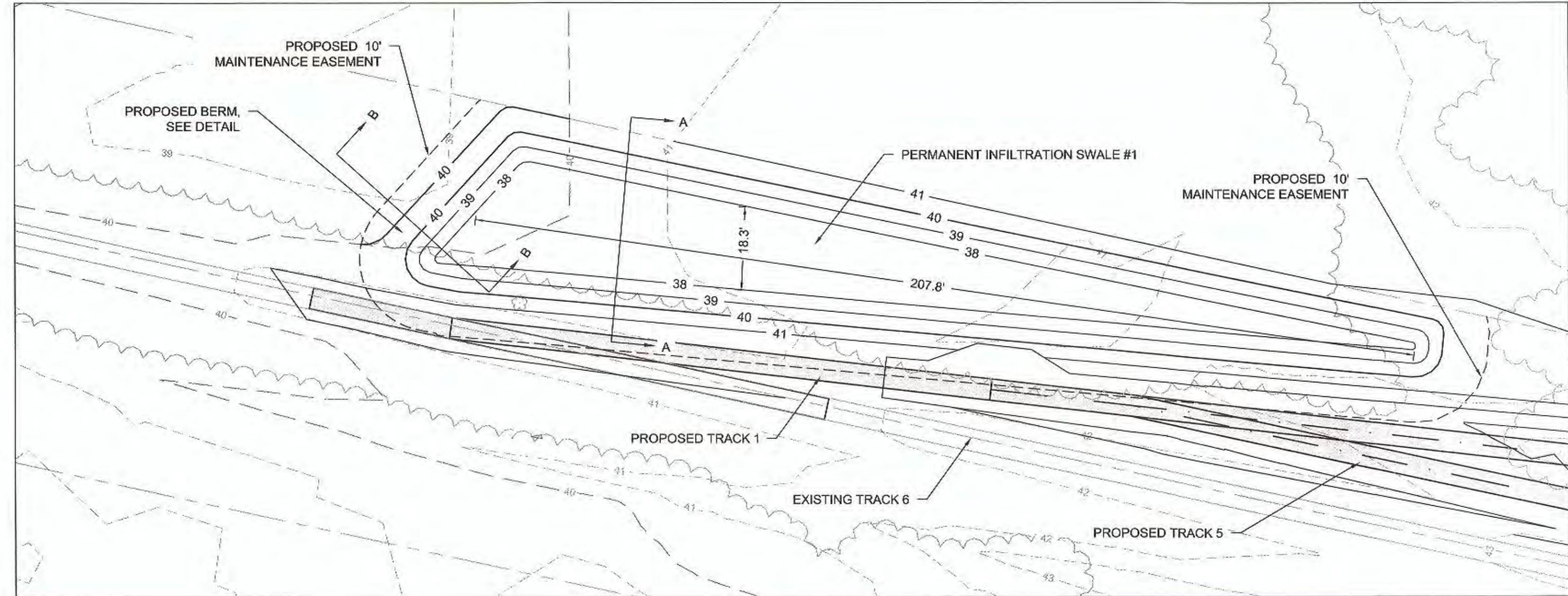

PERMANENT INFILTRATION SWALE #1

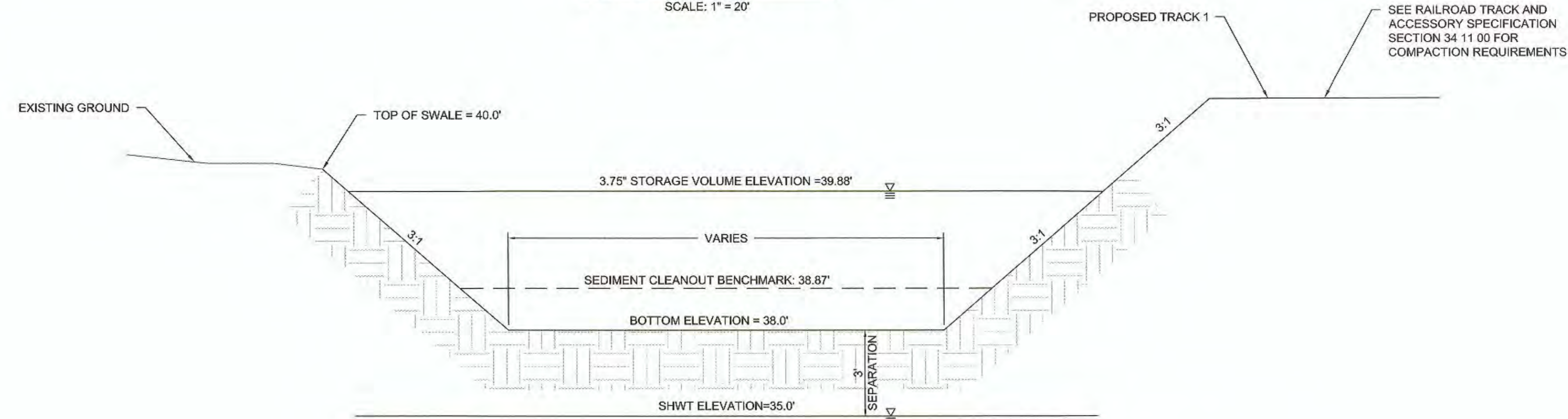
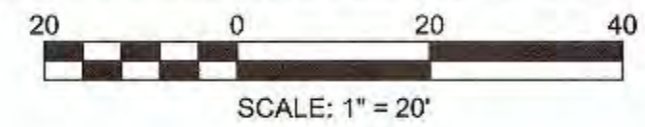

PERMANENT INFILTRATION SWALE #1 SECTION A-A
NOT TO SCALE

* INFILTRATION RATE FOR INFILTRATION BASIN #1: 30"/HR

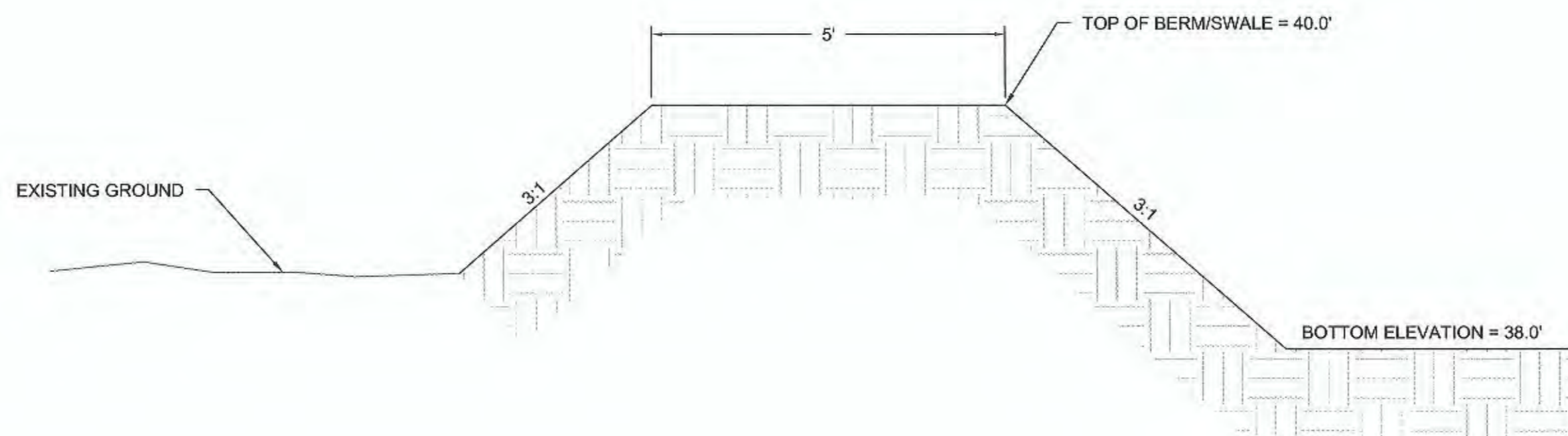

PROPOSED PERMANENT INFILTRATION SWALE #1 BERM SECTION B-B
NOT TO SCALE



LEGEND

EXISTING MAJOR CONTOUR	---
EXISTING MINOR CONTOUR	- - - -
PROPOSED MAJOR CONTOUR	_____
PROPOSED MINOR CONTOUR	_____
EXISTING TRACK	=====
PROPOSED TRACK	=====

WK DICKSON
community infrastructure consultants

908 MARKET STREET
WILMINGTON, NC 28401
(910) 782-4201
(910) 782-4200
WWW.WKDICKSON.COM
NC LICENSE NO. F-0374

NO.	DATE	DESCRIPTION	BY

PROJECT NAME: RAIL AND SITE IMPROVEMENTS PHASE 1 FOR VERTEX RAILCAR CORPORATION, 202 RALEIGH STREET, WILMINGTON, NORTH CAROLINA 28412

DRAWING TITLE: STORMWATER MANAGEMENT DETAILS

PROJ. MGR.: DLF
DESIGN BY: DED
DRAWN BY: TJC
PROJ. DATE: AUGUST 2015
DRAWING NUMBER: **C7.3**
WKD PROJ. NO.: 20150016.00.WL

PRELIMINARY - DO NOT USE FOR CONSTRUCTION PLOT DATE: 9/8/2015